

# Plastic coated steel flange PA10/16

Art -No	Dimension (mm)	Inch/mm	Colour	Fits Arts-No	System			d1	D	PCD	d2	b	z
					.	.	.						
15712	32 mm PA10/16	1 1/4" 32mm	Black	15512	.	.	.	42.00	116.00	85.00	116.00	15.50	4.00
15714	40 mm PA10/16	1 1/2" 40mm	Black	15514	.	.	.	51.00	141.00	100.00	18.00	17.50	4.00
15716	50 mm PA10/16	2" 50mm	Black	15516	.	.	.	62.00	151.00	110.00	18.00	17.50	4.00
15718	63 mm PA10/16	2 1/2" 63mm	Black	15518	.	.	.	78.00	166.00	125.00	18.00	19.00	4.00
15720	75 mm PA10/16	3" 75mm	Black	15520	.	.	.	92.00	186.00	145.00	18.00	19.00	4.00
15722	90 mm PA10/16	3 1/2" 90mm	Black	15522	.	.	.	110.00	201.00	160.00	18.00	21.00	8.00
15724	110 mm PA10/16	4" 100mm	Black	15524/15526	.	.	.	133.00	221.00	180.00	18.00	22.00	8.00
15726	125 mm PA10/16	5" 125mm	Black	15527	.	.	.	167.00	251.00	210.00	18.00	26.00	8.00
15730	160 mm PA10/16	6" 160mm	Black	15530/15531 2155530	.	.	.	178.00	286.00	240.00	22.00	27.00	8.00
15734	200 mm PA10/16	8" 200	Black	15534/15535/ 315534/2515534	.	.	.	235.00	341.00	295.00	22.00	28.00	8.00
15738	250 mm PA10/16	10" 250mm	Black	15543/2515542	.	.	.	288.00	406.00	350.00	22.00	31.00	12.00
15742	315 mm PA10/16	12" 315mm	Black	15543/2515542	.	.	.	340.00	460.00	400.00	22.00	34.50	12.00
15744	355 mm PA10/16	14" 355mm	Black	15545/2515544	.	.	.	380.00	520.00	460.00	22.00	39.00	16.00

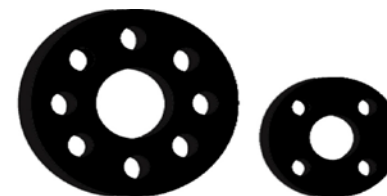
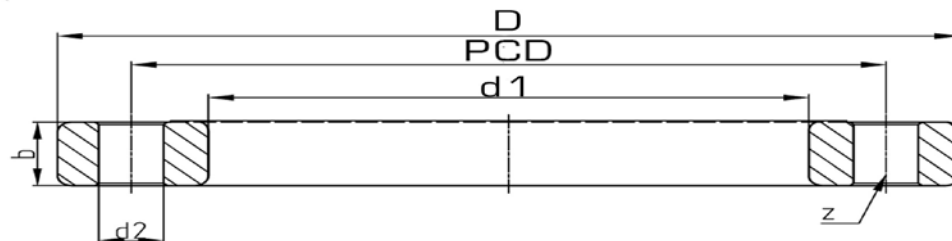

# Galvanised Table E flange

Art -No	Dimension (mm)	Inches/mm	Colour	Fits Arts-No	System	d1	D	PCD	d2	b	z
16716	50 mm Galv B / Flange	2" 50mm	HDG	15516	• • •	62.00	151.00	114.00	18.00	14.00	4.00
16718	63mm Galv B / Flange	2 ½" 63mm	HDG	15518	• • •	78.00	166.00	127.00	18.00	14.00	4.00
16720	75 mm Galv B / Flange	3" 75mm	HDG	15520	• • •	92.00	186.00	146.00	18.00	14.00	4.00
16721	90/75 mm Galv B / Flange	3" 75mm	HDG	15522	• • •	110.00	186.00	160.00	18.00	14.00	4.00
16722	90 mm Galv B / Flange	3 ½" 90mm	HDG	15522	• • •	110.00	201.00	160.00	18.00	16.00	8.00
16724	110 mm Galv B / Flange	4" 100mm	HDG	15524/15526	• • •	133.00	221.00	178.00	18.00	17.00	8.00
16726	125 mm Galv B / Flange	5" 125mm	HDG	15527	• • •	167.00	251.00	210.00	18.00	17.00	8.00
16730	160 mm Galv B / Flange	6" 150mm	HDG	15530/15531	• • •	178.00	286.00	235.00	22.00	17.00	8.00
16734	200 mm Galv B / Flange	8" 200mm	HDG	15530/15531	• • •	235.00	341.00	292.00	22.00	19.00	8.00

